

# 32" Adjustable Railing Planter

## Installation Instructions

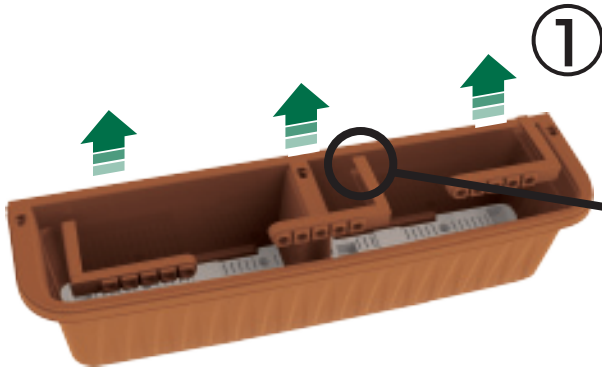

①

Remove railing brackets, pins & metal clip from drainage tray:  
3x railing brackets, 3x pins, 1x clip  
**IMPORTANT:** You will find locking pins nested in railing brackets.

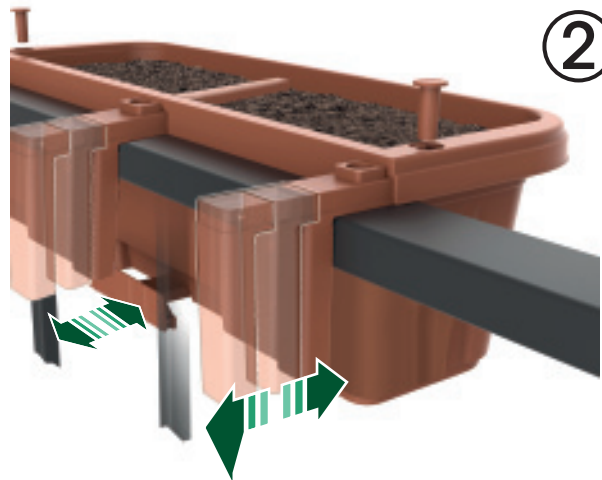

②

Attach railing bracket from below planter sides and middle at the desired width.

Railing brackets can be adjusted to fit a railing up to 4".

**IMPORTANT:** The bracket **MUST** lock into place. If the pin does not sit flush with the planter, then the bracket is **NOT** seated correctly. The lower arms must be used, as they stabilize and support the weight of the planter.

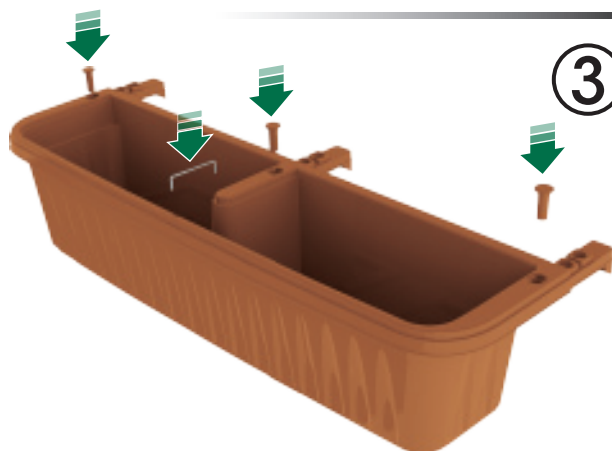

③

Secure planter to the railing and insert locking pins x 3 & the metal clip x 1. You are now ready to plant.

**IMPORTANT:** You will find locking pins nested in railing brackets.